



A K T U E L L

No. 70 | Spring 2022

Information for customers and staff



Unrivalled flexibility

*New features for the
BA 916 and BA 926*

Facelift for the flagship

*Highest capacity self-propelled
Chippertruck hybrid 2.0*

Superlative shredder technology

*New model
Biomass processor BA 1016*

JENZ Professional Days 2022

Major customer event in June

Preface	3
Unrivalled flexibility	4
New features for even greater flexibility and efficiency with the BA 916 and BA 926	
Facelift for the flagship	7
Highest capacity self-propelled Chippertruck hybrid 2.0 impresses with technical innovations	
Superlative shredder technology	10
New model of the former largest JENZ biomass processor BA 1016	
JENZ Professional Days 2022	13
In-house trade fair for customers and sales partners offers many technical highlights	
New JENZ dealer in Great Britain and Ireland	14
CRJ Services Limited took over sales of JENZ machines as of 1 February 2022	
Trade fair dates	16
News briefs	16

Masthead

Produced by:
 JENZ GmbH Maschinen- und Fahrzeugbau,
 Wegholmer Str. 14, 32469 Petershagen
 Phone: +49 (0) 5704/9409-0
 Fax general: +49 (0) 5704/9409-47
 Fax spare parts: +49 (0) 5704/9409-40

© May 2022

Liable for content under German press law:
 Elisabeth Holland
 Editorial: Elisabeth Holland, Gesa Hammon
 Layout: Andrea Werner

We have taken great care with the content of this publication, nevertheless we cannot be held liable for any technical changes, discrepancies etc.



Dear readers,

Who would have thought that the global and economic situation could change so drastically in such a short period of time? Since 24 February 2022 war has been raging in the Ukraine – in the heart of Europe; just a two-hour flight from Germany. The horrific images from Mariupol and Bucha shock the whole world and suddenly make our day-to-day problems seem trivial by comparison.

And yet, life goes on – albeit under different circumstances than before the war started. Among other things increasing energy costs are affecting private and professional life and even the political discussion on expanding renewable energies is facing a new headwind. Dependence on Russian energy imports must no longer jeopardise Germany's future energy security! Quite rightly from our perspective, in February Finance Minister Christian Lindner (FDP), referred to renewable energies as "freedom energies", that could free Germany from dependencies. Woody biomass is precisely one of these renewable energies, this means we are dealing with "freedom energies"! We could also accordingly modify our slogan "Biomass – energy for the future" and say "Biomass – energy for freedom". When this correlation is established it provides a totally different, much more positive appraisal of our own work.

On the other hand, the current upheavals in the procurement markets are unfortunately not so positive. In our last issue this topic was addressed in the preface – given today's perspective the challenges cited at that time could almost be referred to as "marginal".



Extreme price increases over a very short period of time, suppliers transitioning to complete suspension of quotations – what procurement departments have experienced in the past few weeks, must certainly be considered unique in recent history. Consequently, at this time our greatest challenge is to minimise the effects of this special situation to the extent possible. This much I can promise you today: This is what we are working on as our top priority with tact and great sensitivity.

We conclude this preface with a positive outlook: what new technology is coming in 2022? In terms of technology, once again we have many exciting projects in the pipeline, ranging from our smallest PTO chipper, the HEM 542 Z, to the strongest JENZ shredder, the BA 1016. This issue of JENZ AKTUELL offers the first look at some of these projects. You also have the opportunity to experience our latest innovations live at our Professional Days event in June.

I look forward to seeing you there and extend my best wishes for your reading enjoyment!

Your

Unrivalled flexibility!

New features for even greater flexibility and efficiency with the BA 916 and BA 926



Whether combustible material, biogas substrate or compost: Both of our biomass processors can handle all applications; in addition with short retooling times they also offer the flexibility to process timber and green waste.

Petershagen (ghm). In 2020, JENZ set new standards in throughput and flexibility with introduction of the new shredder generation BA 916 and BA 926. Both machines are specially designed for cost-effective operation. Now JENZ has given the two machines a smart facelift, and has optimised the two newcomers for even greater productivity and flexibility.

Biomass potential fully exploited

Green waste, roots, bark, scrap wood or logs, both biomass processors can be deployed in virtually any material, "In our various demonstrations we have even shredded mattresses and chocolate", points out Product Manager Dominik Meden with a smile and again underscores the versatile implementation possibilities. The rotor system can be equipped either with **free-swinging tools** or **fixed tools**; this enables classic **composting** applications as well as **shredding** applications. Both machines can easily produce combustible material, in particular from material that push chippers to their limits. In addition to the equipment with sharp blades on the fixed rotor tools and use of the new two-piece **lamella screen basket**, the shredder mode appropriate for the material can be selected at the touch of a button. This command automatically converts roller pressure and virtually all other machine parameters to the shredding application. Also the construction of both shredders has effects

on the end results, which are similar to wood chips. Whether this is due to the long and low belt hopper, which ensures optimal infeed of long bulky material, or to the repositioning of the lower feed roller, which conveys the material to the rotor in a controlled manner.

With regard to flexibility, the BA 926 offers an additional highlight: the **TwinGear system**. **With a total of four work speeds, the TwinGear system enables fast changeover between chipping applications and shredding applications.** "This is not available in any other high-speed device on the market", emphasizes Product Manager Dominik Meden. Touch a button to activate machine changeover from composting, where fast rotational speeds defibrate [825 rpm (Eco) or 950 rpm (Power)], to the reduced speed range [434 rpm (Eco) 500 rpm (Power)] to guarantee a defined material cut.

New hydraulic system

JENZ Smart Hydraulic More productivity – less power loss

- Extremely fast adaptation of the new GFA (Grinder Feed Assistant) intake control system
- More precise control of all hydraulic processes
- Maximum efficiency through optimal engine capacity utilisation
- Valves with diagnostic capability for machine operators and the JENZ Service



Urs Villiger (left) and Peter Hofer
compost and biogas plant employees



COMPANY	Organisation Murimoos werken und wohnen*
LOCATION	Muri, Canton Aargau, Switzerland
FOUNDED	1932
SERVICES	A diversified production and service portfolio (Wood products, gastronomy, home economics, biological agriculture; composting and biogas plant)

*Offers protected jobs and residential possibilities for people with mental disabilities, addiction problems, and minor cognitive or physical impairments.

The BA 916 is particularly impressive with its versatility and excellent workmanship. The machine is extremely well

designed; this is particularly evident in the accessibility for maintenance. You would think this is a Swiss product.

JENZ Aktuell: «Murimoos werken und wohnen» has been producing compost at its own facilities for more than 30 years. Since 2019 the biomass has been converted into energy in a biogas plant before composting. What tasks does the BA 916 green waste specialist handle in this process chain?

Urs Villiger: "At our collection point, we primarily take in green waste from municipalities and landscape gardeners. The BA 916 processes this green waste for **composting** and for our own **biogas plant**. We use **free-swinging tools** combined with HK heads or armoured blades for this processing step. In addition, we leave the screen basket open."

Peter Hofer: "The delivered material also includes woody material, such as trunks, branch material and sawn timber. With **stationary easycut tools** and a 120 gauge rhombus screen basket, the shredder produces **outstanding combustible material**, which we feed into our own wood chip heating plant. In addition, we can easily increase the roller contact pressure via the controller, and thus we can effectively control the intake of log wood".

JA: Your biogas plant supplies approximately 300 households with power. Your own wood chip heating system supplies heat to all company buildings. To achieve adequate capacity utilisation, in addition to a large quantity of biogas substrate or combustible material, a high-performance machine is also required. How does the BA 916 perform in this regard?
UV: "The **throughput capacity** has **doubled** compared with our previous machine from a different manufacturer. Primarily, we consider that this is due to the particularly good intake behaviour. Our processing regularly changes over between green waste and woody biomass. Since the **GFA system** always perfectly matches rotor speed to intake speed, this means that the engine is uniformly utilised and we achieve corresponding high throughput capacities. We must also mention the **high-precision handling of foreign objects**. The BA 916 reacts to foreign objects with incredible speed and protects itself from consequential damage."

JA: Whether taking in green waste or supplying the wood chip heating system – your employees change the applications within

the entire composting plant. In this respect it is particularly important that all participating machines are user-friendly. How do you rate the BA 916 for typical everyday tasks?

PH: "In our facilities the machine operators change regularly. This means that effective man-machine communication and extremely simple and quickly understandable machine operation are the key priorities. These are precisely the priorities that JENZ has implemented: Individually adjustable user profiles, selectable material-dependent **shredder modes**, a **smartphone-like remote control unit** as well as easily visible **status displays on the roof of the engine enclosure**."

Biogas plant Muri:

- Dry fermentation of green waste and solid manure
- Supplies power to 300 households
- Supplies heat to company buildings
- Digestate in post-rotting compost for agriculture and gardening





Managing Directors Detlef Meyer (left) and Stefan Meyer



Machine Operator Jan Holsten



COMPANY Helmuth Meyer GmbH & Co. KG
LOCATION Grauen near Hamburg
FOUNDED 1927 by Otto Meyer
SERVICES excavation, earthwork and demolition work, recycling, container service, scrap wood processing

“ We try to make a product out of everything that we use up somewhere. The BA 926 is a perfect fit for our team. ”

Managing Director Stefan Meyer concerning the profitability of the BA 926:

"Our principle is simple: If the shredder is flexible, then so are we. Ultimately the interaction of flexibility and productivity of the shredder determines how profitably we are acting as a company. At our facility the BA 926 is an absolute material all-rounder, in addition to green waste, it also processes scrap wood and tree stumps. From the green waste, the shredder produces **optimal structure material** for composting. The utmost quality is required for processing scrap wood into combustible material. With the BA 926 we can produce different grains and we obtain **clean end material** for energetic utilisation thanks to powerful over-belt magnets. Particularly with light cuttings and root wood we have been able to considerably **increase throughput rates** compared to the predecessor machine. This is primarily due to the fact that the intake behaviour, either because of the greater intake height or the optimised take-in speed, has significantly improved relative to the BA 725."

Machine Operator Jan Holsten concerning the everyday work with the BA 926:

"Charging the BA 926 is actually quite fun! There is a huge difference relative to the predecessor, the BA 725. It starts with the intake: **More pressure on the upper roller**, a different arrangement of the lower roller, an **enlarged inlet opening**, plus greater autonomy of the machine itself. Large rootstocks can be easily pulled in without pushing. This is executed so quickly that it really makes you sweat as operator, and an empty belt hopper sparks the ambition of every excavator operator. However, this is somewhat self-inflicted: After all, I set up the "maximum intake speed" function so it can be activated via a button on the remote control unit. For our processing purposes we primarily equip the BA 926 with fixed tools. The different rotational speeds offered by the **TwinGear system** also influence the quality of the end product, and this is what I find really fascinating about the machine: I get the desired end product directly with

just one work step. Best example: Equipped with a mesh size 50 screen basket and stationary tools, the BA 926 shreds tree stumps into **high-quality, profitable heating material**. With 150 hp more, the PS 926 offers higher engine power than the BA 725. Of course, this results in higher fuel consumption, but the throughput is also much higher. In short: What I used to shred in two days, I now shred in one. To sum up, the BA 926 is more cost-effective than its predecessor and impresses me each day anew with its **incredible throughput capacity**."



First the BA 725, now the BA 926: The company, Helmuth Meyer, had already had many years of experience with the predecessor BA 725. For more than 6 months now the company has been successfully shredding with the versatile BA 926.

Facelift for the flagship

Highest capacity self-propelled Chippertruck hybrid 2.0 impresses with technical innovations

+++ Europe-wide without special approval

In spite of this performance class, the Chippertruck hybrid has a machine weight of less than 32 t.

Petershagen (ghm.) The Chippertruck hybrid is the flagship among the JENZ mobile chippers. The HEM 922 DQ shredder unit was introduced in early 2021. To make things easier, effective immediately the machine is being marketed under the name "Chippertruck hybrid".

The technical changes on the large chipper again show due consideration of the aspects: chipping quality, fuel consumption, driving comfort and flexibility. Sebastian Breuer is the new Product Manager for chipper technology. He explains the diverse innovations in detail.



JENZ Product Manager
Sebastian Breuer

“ Chippertruck hybrid, version 2.0 – “

What's behind the update?

"Currently wood chips are becoming more and more important as an energy source. However, wood chip production must also be efficient and economical. Specifically this means: Produce high quantities in a short time and always with due consideration of quality, fuel consumption and

flexibility. This was our guiding principle for the facelift of the Chippertruck hybrid. In short, achieve more of everything: More comfort, more capacity, more quality, more throughput. There were only two things where we ended up with less: Wear and fuel consumption!"

MORE DRIVING COMFORT

New MAN TG3 cab



Now it is even easier to move the operator seat forward. The shift lever for the automatic transmission is placed conveniently next to the right joystick.

New interior – more comfort at the workstation:

- User-friendly cockpit
- Versatile infotainment system with high-resolution 7-inch colour display, DAB+ radio, integration of mobile end devices, Bluetooth® music streaming
- Protective assistance systems, such as the adaptive cruise control (relieve the driver of some driving tasks, particularly on monotonous trips)
- Active seat temperature control for the driver seat and operator seat



New TG3 driver's cab – modern and powerful:

For example, this is manifest in the front headlight section with state-of-the-art LED technology and the dynamic side design. The streamlined exterior reduces both fuel consumption as well as dirt and grime on the vehicle.



RESISTANT, SUSTAINABLE AND ROBUST

New D1.2 drum design

In recent years the rotor that is most frequently installed; the D1 rotor is one of the trailblazers when it comes to wood chip quality. The quality has again been optimised, and so has the material flow, both on the basis of minor but

extremely well thought-out measures. From the operator's perspective the advantages are minimised wear and improvement of the daily maintenance tasks.



Chamfering on the rotor discs

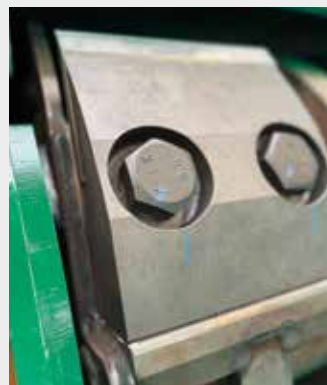

Cut-outs on the outer rotor discs



Lower-positioned support shafts

WOOD CHIP QUALITY PAR EXCELLENCE

High-performance auxiliary motor combined with a new drum speed concept



+++ Without AdBlue
In spite of the new emission standard even without AdBlue as before.

Conversion to the latest EU Stage V emission standard – Auxiliary engine Caterpillar C18:

- Power increase to 597 kW (812 hp) and thus total power increase to 1,322 hp
- Rotational speed reduction to 1,800 rpm results in a significant drop in fuel consumption
- Simultaneous higher tractive power through torque increase to 3710 Nm

Lower rotational speed – more torque

New rotational speed concept on the rotor

At just a maximum of 460 rpm, rotor speed decreases 10% compared to the previous situation and yet at the same time this provides more torque. The result is an even better wood chip quality with increased throughput, and additionally optimised wear behaviour.



INCREASING EFFICIENCY "JENZ Smart Hydraulic"

The two intake control systems CFA and CFA 2 relay material-dependent information concerning rotor speed and opening angle of the upper roller to the easy2 controller. Forwarded to the intelligent hydraulic system; this information ensures a fast, precise adaptation of the intake speed. The operator merely specifies top roller pressure and maximum intake speed by pressing a button.

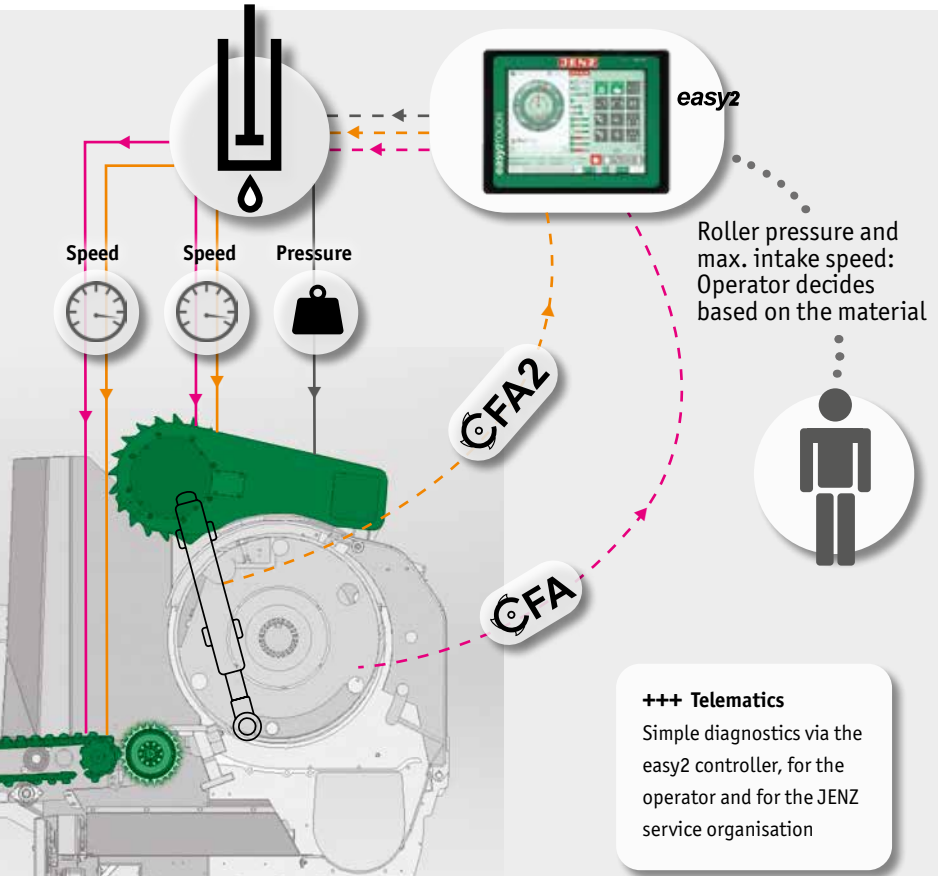

Roller pressure and max. intake speed: Operator decides based on the material

+++ Telematics
Simple diagnostics via the easy2 controller, for the operator and for the JENZ service organisation

- - - - - Electrical signals	— Hydraulic signals
- - - - - Electrical signals	— Hydraulic signals

Superlative shredder technology

New model of the former largest JENZ biomass processor BA 1016

Petershagen (ghm.) What happens when you install an 812 hp powerhouse in a mobile shredder and also combine the whole with intelligent shredder components? Right – you get the largest JENZ shredder to date. Not an easy task for the JENZ Development Team. Particularly given the challenge of building a compact machine that can be put on the road without a special vehicle and special approval. JENZ Aktuell took a behind the scenes look at how the new colossus BA 1016 was de-

veloped and asked Project Head Vincent Ortmann, Design and Development and Dominik Meden, Product Management, what we can expect from this new powerhouse.

JENZ Aktuell: The product group of the JENZ biomass processors consists of a total of four machine types. The high-capacity BA 965 is no longer a component of the JENZ product line. **Direct question:** is the BA 1016 the successor?

Vincent Ortmann: Yes, the essential impetus for development of the BA 1016 was the very positive market acceptance our two newcomers, the BA 916 and the BA 926. Consequently, the necessity for further development of the BA 965 was more than obvious for us.

Dominik Meden: Through worldwide deployments and demonstrations with these two shredders we gained fundamental experiences which verified that the machines are extremely mature technically. This starts with the optimal intake geometry, followed by the pronounced user-friendliness and extends to the new "JENZ Smart Hydraulic" system. In addition, there is the screening technology for shredding applications, which is newly developed for the BA 926. The logical decision was to ensure that this knowledge was not lacking in the new BA 1016!

JA: A brief interposed question: Why the name BA 1016?

VO: The machine has a powerful **CAT C18 engine with 812 hp**, a large rotor diameter and a large inlet opening – an entirely new dimension in our shredder program. Given these capacity increases a delimitation to the 9-series is necessary. Thus

Higher, faster, farther: A specially developed discharge conveyor ensures fast and uniform material flow.

with the BA 1016 we not only introduce a new series, we also leave ourselves adequate scope for future developments (he smiles).

JA: The CAT C18 is used in the most powerful configuration level. How do you integrate such a huge engine, and first and foremost what advantages are offered by using the C18?

VO: The powerful C18 gives the BA 1016 extreme tractive force. The downside: such a large engine requires space. As a team we needed a few ideas, on the one hand to accommodate this in way that offers easy maintenance, and on the other hand to maintain a suitable roadworthy machine width.

DM: We consider the fact that it continues to do just fine without **AdBlue** and yet also meets the Stage V requirements, as particular advantages of the C18. The distinctive torque curve makes it possible for us to work at rotational speeds that reduce wear and save fuel and yet still increase throughput. In this regard, maximum efficiency and throughput capacities of more than 400 m³ were the objectives.

JA: In the development process for the two newcomers, the BA 916 and BA 926, we brought the operator into absolute focus. Specifically this means a smartphone-like controller, intelligent assistance systems and ergonomic maintenance that together ensure a pleasant and high-throughput workday for the machine operator. Are all of these innovations also in the BA 1016?

VO: Yes, naturally for this new development the focus was also on the operator and reliance on proven components, such as the **easy2 controller**, the **Operator Info system** or the **two-piece screen basket system**. The latter makes screen basket replacement fast and ergonomic, since it can be handled by one person.

JA: You mean "JENZ Smart Hydraulic" – the newly implemented hydraulic system?. At what points is this new system significantly noticeable?

"Maximum efficiency and throughput capacities of more than 400 m³ were the objectives here."

"The powerful C18 gives the BA 1016 extreme tractive force."

"The result: extremely clean end material."

VO: Clearly in the intake area. Thanks to the new system, at intake we have a clearly improved control behaviour. In short: we can selectively keep the auxiliary engine lugging and thus can use the **complete performance spectrum of the engine** and selectively bring it selectively to its capacity limit. This results in **more throughput**, paired with **lower fuel consumption**. Additional advantage: the machine and the auxiliary engine are protected by the quieter, constant operation.

JA: Given its inlet width of 1,620 mm and height of 960 mm the BA 1016 can process large quantities of material and thus achieves the primary development objective of increased throughput potential. However, critically we could say: If the material cannot flow out promptly, without obstruction, material discharge quickly becomes the limiting factor. How does the BA 1016 handle this issue?

DM: To ensure that the material flows with low fuel consumption and low wear, we rely on an extra-large screen surface and a specially developed discharge conveyor. Here the motto is: Higher, faster, farther. The new intelligent JENZ Smart Hydraulic with more than 40% increased capacity, shows its advantages at infeed and also at material discharge. Overall the conveyor has become longer and wider and scores with **increased delivery speed**. This means that now even heavy material can be conveyed on high transport vehicles with a maximum drop height of 5.10 m. Thanks to the increased width and the selected profile the material layer thickness is reduced and the magnets can optimally clean the material. The result:

extremely clean end material. Additional advantage of the new conveyor: reduced machine length. This is ensured by a different



folding technology, that enables machine transport without either special approval or a special vehicle.

JA: The high-performance Caterpillar engine is characteristic for the BA 1016 and in conjunction with the new JENZ Smart Hydraulic, an optimised conveyor and a large portion of user-friendliness, it is clearly a revolution in the area of biomass processors. What are the future opportunities for the new flagship?

VO: We are proud of the fact that we succeeded in combining 812 hp and a compact transport length of 10.55 m.

After all, this is more than one meter shorter than the BA 926. With the BA 1016 we have produced a mobile, high-performance

shredder with technology that remains simple. In particular, the easy handling will ensure worldwide deployment for this shredder, even in remote regions.

DM: Through the energy transition heating material obtained from scrap wood and roots is in ever increasing demand, and this means that powerful machines are becoming more and more significant.

Likewise, given the increasing fertiliser prices, the compost market is demanding shredders with ever greater performance. These are precisely the points where the advantages of the BA 1016 with its efficiency and incredible throughput capacity are brought to bear.

"Powerful machines are becoming more and more significant."

brief facts BA 1016			
Performance potential	Intake	Main drive unit	Shredding unit
Throughput up to approx. (in m ³)	Inlet width (mm) 1620	Standard diesel engine CAT C18	Rotor diameter (mm) 1120
Green waste 430	Inlet height (mm) 960	Drive power kW/hp 597/812	Number of fails 34
Bark 440	Free feed length (mm) 4500	Conveyor discharge	
Scrap wood 310		Drop height (mm) 5100	
Roots 190			



From first sketch to the finished BA 1016: Product Manager Dominik Meden (left) and Designer Vincent Ortmann discuss the current production progress of the future powerhouse shredder BA 1016.



JENZ PROFESSIONAL DAYS 2.0

In-house trade fair for customers and sales partners offers many technical highlights

Petershagen (ehe). At long last, it's happening! After a forced two-year hiatus, in spring 2022 the first trade fairs and events are coming back. The JENZ highlight this year is the Professional Days event at the company's headquarters facilities in Petershagen – Friedwalde.

"After the first successful start of JENZ Professional Days in 2019, it was clear to us that there would be a continuation of the in-house trade fair", explains Elisabeth Holland, Managing Director. "This event was originally planned for 2021 – appropriate for the 100th anniversary of the company – however corona did not allow any major events. This makes it even nicer that now we are on again!"

The **program for this year's Professional Days is nothing to be ashamed of**: The new model of the compact PTO chipper HEM 542 Z, the premier of the largest JENZ shredder, the BA 1016, or presentation of the new MAN TG3 cab concept – exciting innovations and authentic ambience in the JENZ Chipping Arena ensure major anticipation!

It starts on the long Corpus Christi holiday weekend with **two exclusive days for customers and invited guests on 16/17 June**. The event ends on **Saturday 18 June with an open house** with family program and career day for everyone.





New JENZ dealer in Great Britain and Ireland

CRJ Services Limited has been responsible for sales and service since 1 February 2022

Knutsford, Cheshire, UK (CRJ Services/ghm). For approximately 30 years Westcon Equipment Ltd. was responsible for sales and service of JENZ machines in Great Britain and Ireland. On 31 January 2022, the team headed by Neil Bond ceased operation due to lack of a successor. Now CRJ Services Ltd. a new strong partner has taken over the JENZ representation on the Island. We introduce the company and its successful development over the recent decades.

CRJ Services was founded in 1999. The impetus was the decision of the managing director at the time to transition from agriculture to organic recycling for municipalities.

By renting out its existing recycling equipment the company grew quickly and expanded its machine fleet. Today CRJ Services has a rental fleet of more than 110 machines, including screening machines, slow-running and fast-running shredders as well as air separators and eddy-current separators.

With an extensive rental fleet the firm services all types of waste disposal and recycling companies. From small rubbish collection companies to large waste disposal enterprises. In addition to the rental business, over the years the team has also concentrated on sales of well-known brands like HAAS, Steelweld, Weima and Bruce Engineering. Since the beginning of the year, the sales portfolio has now been supplemented with the JENZ brand, thus with mobile shredders and biomass processors.



CRJ Managing Director Rob Symons

"CRJ Services is passionately committed to recycling, sustainability and an efficient closed-loop economy. Over the years the machines we use have contributed towards recycling millions of tonnes of waste, and this has enabled our customers to save costs and manufacture saleable products."



In selecting its trademarks, CRJ relies on clear guidelines: They must be industry leaders, high-performance, and high-quality. Moreover, the brands have been strategically selected such that multiple areas associated with recycling, waste management and the forestry sector are covered, explains Rob Symons, one of the three managing directors, in addition to Ben McQuaid and Lee Carter. "With this relationship we are in a position to offer machines for all requirements of the constantly developing waste management and forestry sectors."

First-class after sales service is an important component of the corporate philosophy. In this regard the team relies on field service technicians that are strategically distributed throughout the United Kingdom and Ireland, and who can quickly respond to the needs of its customers. In addition, there is a strong team of manufacturer-trained workshop employees at the firm's headquarters in Cheshire.

The extensive knowledge of diverse material processing machines offers first-class service for the customer that ensures efficient operation and minimises machine downtimes. The after-sales package is rounded out with an offering of quickly-available, cost-effective original spare parts and wear parts. "Thus we honour our commitment of offering the best after-sales service in the industry and of optimally taking care of our customers, before, during and after the sale," points out Symons.



CRJ Managing Director Ben McQuaid

"CRJ Services is pleased to establish a strong relationship with the manufacturer JENZ and with the new and old JENZ customers, as the company continues its strong growth. Since we, along with JENZ, place a high priority on outstanding service, JENZ customers in Great Britain and Ireland can be sure that they are in good hands with CRJ services."



Date	Trade fair	Location	Company
Trade fair dates JENZ 2022			
May 2022			
30/05/2022 – 03/06/2022	IFAT	Munich, Germany	JENZ
30/05/2022 – 03/06/2022	10th VDMA Practice Days	Munich, Germany	JENZ
June 2022			
09/06/2022 – 11/06/2022	TKD	Almere, Netherlands	Van Laecke
16/06/2022 – 17/06/2022	JENZ PROFESSIONAL DAYS	Petershagen, Germany	JENZ
July 2022			
29/07/2022 – 01/08/2022	Foire de Libramont	Libramont, Belgium	Van Laecke
August 2022			
02/08/2022 – 03/08/2022	Demo Forest	Bertrix, Belgium	Van Laecke
September 2022			
02/09/2022 – 06/09/2022	Karpfhamer Fest	Karpfham, Germany	JENZ
03/09/2022 – 04/09/2022	Matexpo Demo Days	Terril Saint-Antoine in Boussu, Belgium	Van Laecke
16/09/2022 – 17/09/2022	Hurdagene	Eidsvoll, Norway	Magne Gitmark

Status May 2022. Information provided without guarantee.

brief +++ news in brief +++ news in brief +++ news in brief +++ news in brief +++ news in brief +++ news in brief +++



**For a childhood without cancer!
We are committed to CC with
#cancelcancer**

February 15 was International Childhood Cancer Day. In Germany every year there are approximately 2,000 cases of childhood cancer. The research in this area is limited and donations are urgently required.

In conjunction with the Round Table 160 Minden auction, JENZ participated in buying at auction the original Cancel Cancer directors' chair of the campaign and thus actively supports childhood cancer research.

Festival of light at JENZ

The first fibre optic cable in Petershagen. JENZ is now benefiting from Internet services that is approximately 33-times faster and with this capacity the company desires to become even more sustainable. "Through modern transmission technology a lot of business travel is becoming superfluous and also the home office can now be much better organised", states Managing Director Hans Heinrich Hermeier, with satisfaction. The line is even configured for 100-times the speed and thus offers plenty of scope for future developments.



HEM 820 DL

state-of-the-art technology – customary quality

Rotor D1.2 | CAT C18 Stage V | JENZ Smart Hydraulic

Wheels or Caterpillar tracks

